

WIFI connection manual

Notice:

Please read this manual carefully before using products and keep it in the place where O&M providers can easily find. Due to product upgrade and other factors, the content of this manual might change from time to time. Please take actual product as standard and get latest manual from home.aforeenergy.com. Unless otherwise agreed herein, this manual will only be used as guidance. Any statement, information or suggestion in this manual will not take any form of responsibility. Without written permission, any content of this document (partly or entirely) cannot be extracted, copied or transmitted in any form by any company or individual.

Download APP

 **Warning:**
Please remove WIFI Module after power off.



You can Search "Afore Smart PRO" in Apple Store and Google Play.

1. WIFI MODULE INSTALLATION

Type 1: Assemble WIFI Module to the inverter communication interface as shown in the diagram.

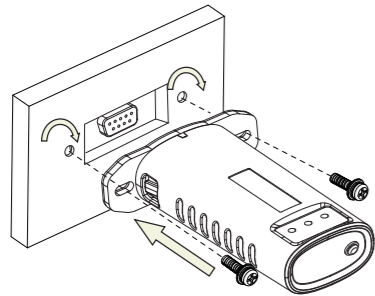

Type 2: Assemble WIFI Module to the inverter communication interface as shown in the diagram.

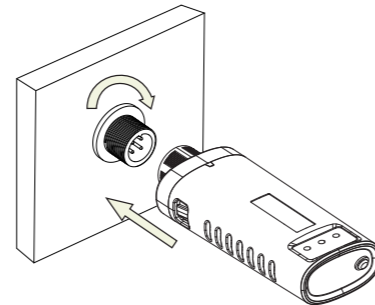

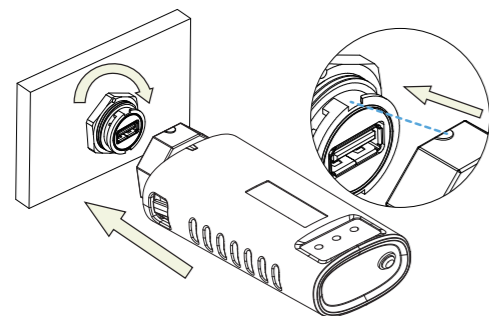

Type 3: Assemble WIFI Module to the inverter communication interface as shown in the diagram.

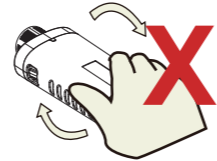

 **Warning:**
Please do not hold the WIFI Module body to rotate while install or remove the Module.





 **Notice:**
Do not remove waterproof plug.



2. WIFI MODULE STATUS

2.1 Check Indicator light

Lights	Implication	Status Description(All lights are single green lights.)
	Communication with router	1.Light off: Connection to the router failed. 2.On 1s/Off 1s(Slow flash): Connection to the router succeeded. 3.Light keeps on: Connection to the server succeeded. 4.On 100ms/Off 100ms(Fast flash): Distributing network fast.
	Communication with inverter	1.Light keeps on: WIFI Module connected to the inverter. 2.Light off: Connection to the inverter failed. 3.On 1s/Off 1s(Slow flash): Communicating with inverter.
	WIFI Module running status	1.Light off: Running abnormally. 2.On 1s/Off 1s (Slow flash): Running normally. 3.On 100ms/Off 100ms(Fast flash): Restore factory settings.



The normal operation status of the WIFI Module, when router connected to the network normally:

- (1) Connection to the server succeeded: NET light keeps on after the WIFI Module powered on.
- (2) WIFI Module running normally: READY light flashes.
- (3) Connection to the inverter succeeded: COM light keeps on.

3. ABNORMAL STATE PROCESSING

If the data on platform is abnormal when the WIFI Module is running, please check the table below and according to the status of indicator lights to complete a simple troubleshooting. If it still can not be resolved or indicator lights status do not show in the table below, please contact Customer Support.

(Note: Please using the following table query after power-on for 2mins at least.)

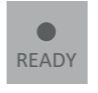
NET	COM	READY	Fault Description	Fault Cause	Solution
					
Any state	OFF	Slow flash	Communication with inverter abnormal	1.Connection between WIFI Module and inverter loosen. 2.Inverter does not match with WIFI Module's communication rate.	1.Check the connection between WIFI Module and inverter. Remove the WIFI Module and install again. 2.Check inverter's communication rate to see if it matches with WIFI Module's communication rate. 3.Long press Reset button for 5s, reboot WIFI Module.
OFF	ON	Slow flash	Connection between WIFI Module and router abnormal	1.WIFI Module does not have a network. 2.Antenna abnormal. 3.Router WiFi signal strength weak.	1.Check if the wireless network configured. 2.Check the antenna, if there is any damage or loose. 3.Enhance router WiFi signal strength. 4.Long press Resetbutton for 10s, reboot WIFI Module and networking again.
Slow flash	ON	Slow flash	Connection between WIFI Module and router normal, connection between logger and remote server abnormal.	1.Router networking abnormal. 2.The server point of WIFI Module is modified. 3.Network limitation, server cannot be connected.	1.Check if the router has access to the network. 2.Check the router's setting, if the connection is limited. 3.Contact our customer service.
OFF	OFF	OFF	Power supply abnormal	1.Connection between WIFI Module and inverter loosen or abnormal. 2.Inverter power insufficient. 3.WIFI Module abnormal.	1.Check the connection, remove the WIFI Module and install again. 2.Check inverter output power. 3.Contact our customer service.
Fast flash	Any state	Any state	SMARTLINK networking status	Normal	1.Exit automatically after 5mins. 2.Long press Reset button for 5s, reboot WIFI Module. 3.Long press Reset button for 10s, restore factory settings.
Any state	Any state	Fast flash	Restore factory settings	Normal	1.Exit automatically after 1mins. 2.Long press Reset button for 5s, reboot WIFI Module. 3.Long press Reset button for 10s, restore factory settings.

USER MANUAL for Afore Smart PRO APP

1.REGISTRATION

Go to Afore Smart HOME and register.
Click "Register" and create your account here.
Choose "Registered Merchant" and "Register User" based on the actual situation.

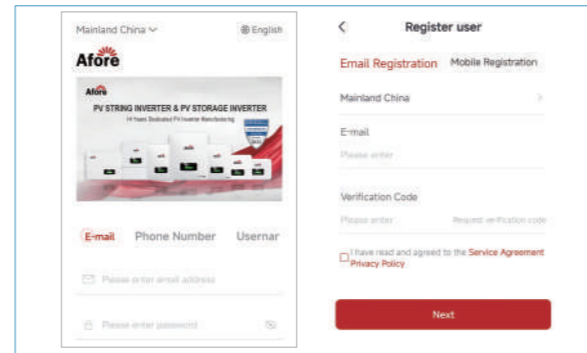

2.CREATE A PLANT

Click the "+" symbol in the upper right corner to create your factory.
Please fill in plant basic info and other info here.

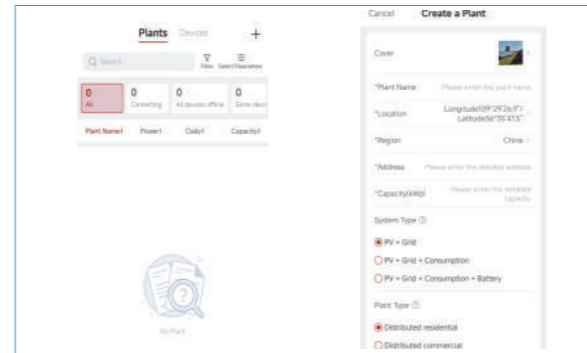

3.ADD A LOGGER

Method 1: Click on the icon and scan to enter logger SN You can find logger SN in the external packaging or on the logger.
Method 2: Enter logger SN manually.

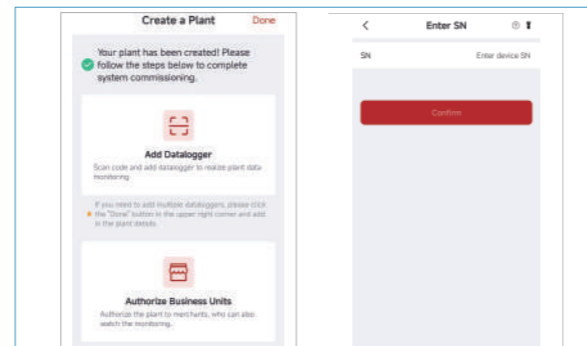

4.NETWORK CONFIGURATION

Click "Wi-Fi Configuration" to set the network.
(Please make sure Bluetooth and WiFi are ON.)

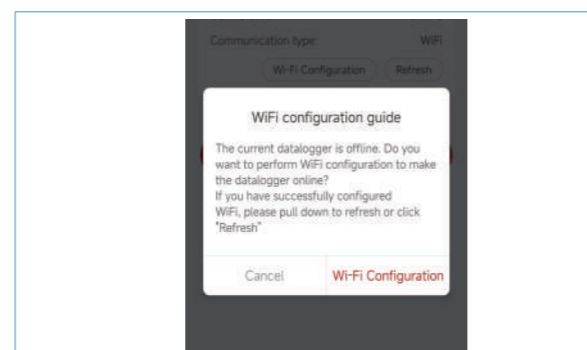

A Confirm Wi-Fi Info

Please make sure your phone has connected to the right WiFi network. And click "Start to configure".

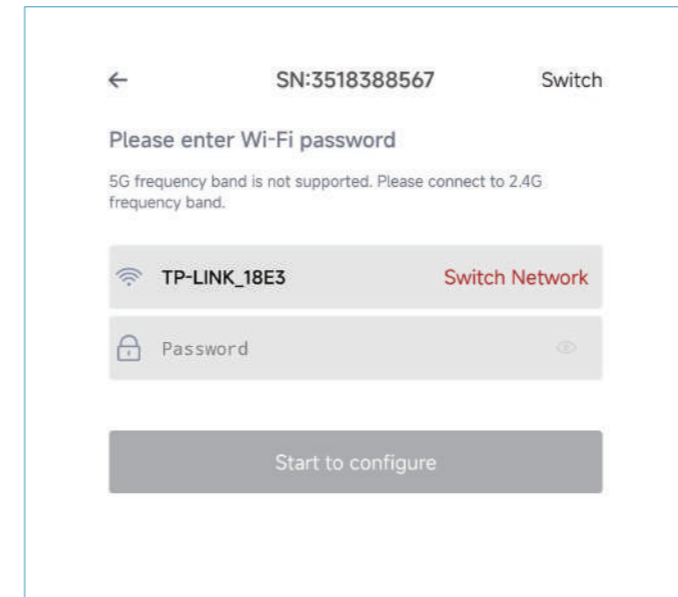
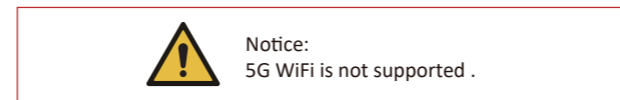

B Connect to AP network

Click "Connect" and find the right "AP_XXXXX" network (XXXXX refers to logger SN).
If the password is required, you can find the password on the WIFI Module body.
Go back to Afore Smart HOME APP, after connecting to AP network.

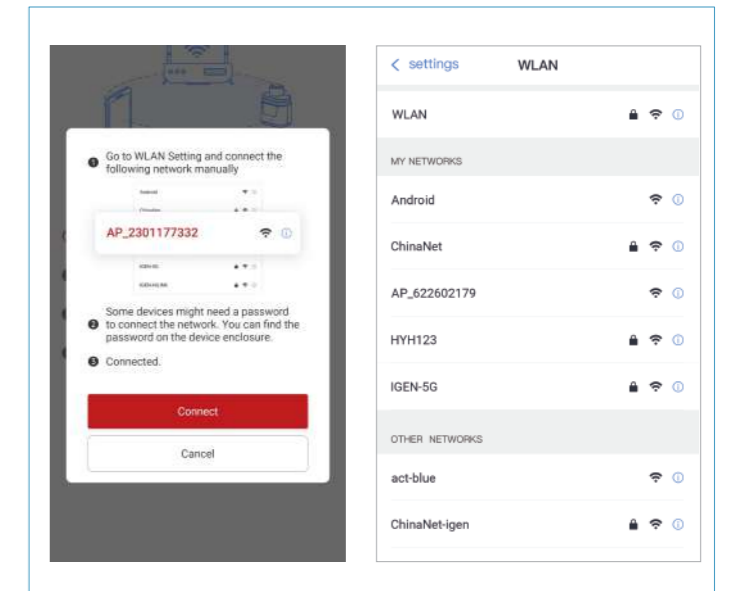

C Auto Configuration

Please wait for a while to complete the configuration. Then system will switch to the following page.
Click "Done" to check plant data. (Usually, the data will be updated in 10 mins)

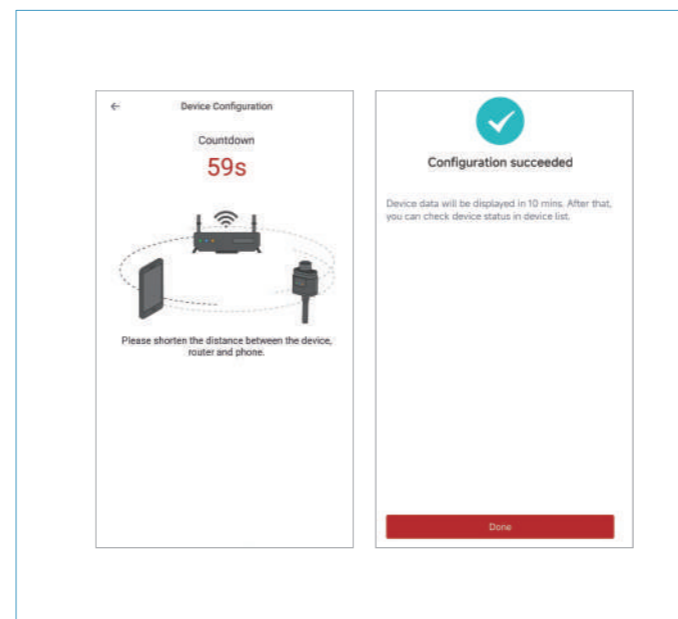

If configuration failure occurs, please check the following reason and try it again.

- (1) Make sure WLAN is ON.
- (2) Make sure WiFi is normal.
- (3) Make sure wireless router does not implement the white-black list.
- (4) Remove the special characters in Wi-Fi network.
- (5) Shorten the distance between the phone and device.
- (6) Try to connect to other Wi-Fi.

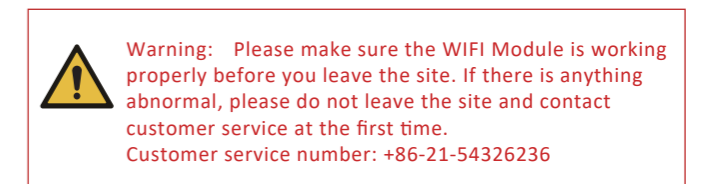

If you have any technical queries about our products, please contact us and provide the following information:
(1) Product model and serial number of WIFI Module.
(2) Product model and serial number of connected inverter.
Thank you for your support and cooperation!