

Web User Manual

Afore Smart HOME Web

www.aforeenergy.com



Afore

Afore New Energy Technology (Shanghai) Co., Ltd.

T 86-21-54326236 F +86-21-54326136 E info@aforeenergy.com

Ad No.2755, Sanlu Rd. Minhang District, Shanghai, China. 201112

Afore

Afore New Energy Technology (Shanghai) Co., Ltd.

Contents

- 1.Instruction 1
 - 1.1 Afore Smart HOME Web 1
 - 1.2 Afore Smart HOME App 1
- 2.Account 2
 - 2.1 Login&Registration 2
 - 2.1.1 Registration 2
 - 2.1.2 Login 2
 - 2.2 Password 3
 - 2.2.1 Forgot Password? 3
 - 2.2.2 Password Modification 4
 - 2.3 Account Binding 4
 - 2.4 Account Cancellation 5
- 3.Plant 8
 - 3.1 Create a plant 8
 - 3.2 Add a Logger 9
 - 3.3 Data View 12
 - 3.3.1 Plant Data 13
 - 3.3.2 Plant Alert 14
 - 3.3.3 Device Info 14
 - 3.3.4 Plant Details 15
 - 3.4 Plant Authorization 16
 - 3.5 Plant Settings 18
 - 3.5.1 Delete Plant. 18
 - 3.5.2 Plant Settings 18
- 4.Message 22
 - 4.1 Messaging 22
 - 4.2 Message Settings 23
 - 4.2.1 Receive Alert Message 23
 - 4.2.2 Alert Range Settings 24
 - 4.2.3 Alert Frequency Settings 25
 - 4.3 Service Plan 25
- 5.Applications 27
 - 5.1 Full Screen Display 27
 - 5.1.1 Steps 27
 - 5.1.2 Settings 28
- 6.Others 30
 - 6.1 Languages 30
 - 6.2 Common Operations 31
 - 6.2.1 Log Out 31
 - 6.2.2 Personal Settings 31
 - 6.2.3 General 32

1. Instruction

1.1 Afore Smart HOME Web

1. Open a browser and enter home.aforeenergy.com to go to Afore Smart HOME Web.
2. Chrome58, Firefox49, IE9 and above version are recommended.

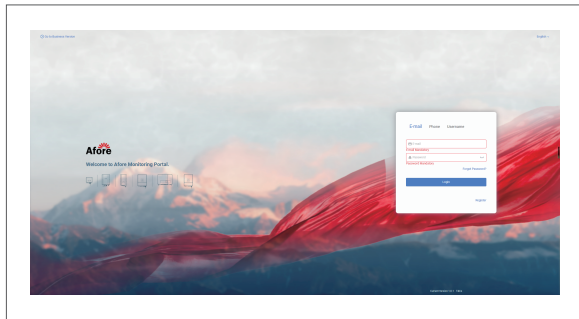

1.2 Afore Smart HOME App

When you are at login page, click "Download APP" to view QR code. If you wish to download Afore Smart HOME App, please scan the QR code and install. (Both android and IOS systems are supported.)

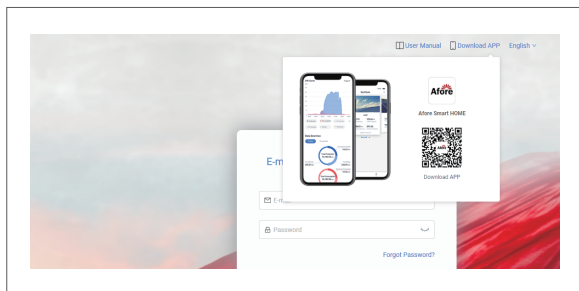

2.Account

2.1 Login&Registration

2.1.1 Registration

After entering Afore Smart HOME Web, please register at Afore Smart HOME Web to ensure the normal function.

Click “Register” to continue.

System supports E-mail or phone (China, Brazil, Netherlands, America) registration currently. Please follow:

- (1) Set login account.
- (2) Set password.
- (3) Tick the box if you agree to T&Cs.

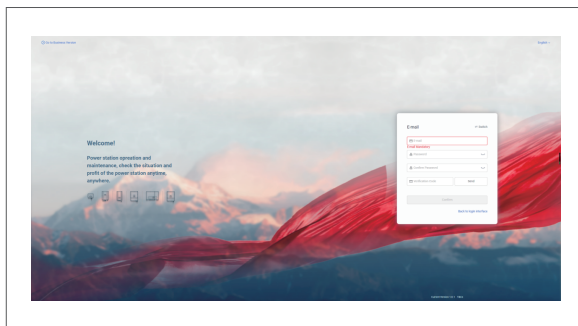

2.1.2 Login

If you have an account at Afore Smart HOME Platform, you can login directly. Quick and easy access via WeChat or QQ is also supported.

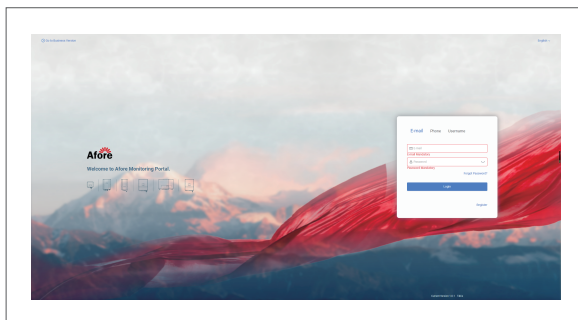

2.2 Password

2.2.1 Forgot Password?

If your password is forgotten, please click “Forgot Password” to find your password back.

(1) If you try to find your password via your phone, please enter your phone number first, then click “Send”. System will send a verification code message to your phone. Please enter the right verification code and reset your password.

(2) If you try to find your password via E-mail, please enter your E-mail address first, then click “Send”. System will send a verification code E-mail to your mailbox. Please enter the right verification code and reset your password.



Note:

If you encounter the following problems, please contact Customer Service.

- Your phone or E-mail has been deactivated.
- Login method is "Username". And your account has not bound your phone or E-mail.

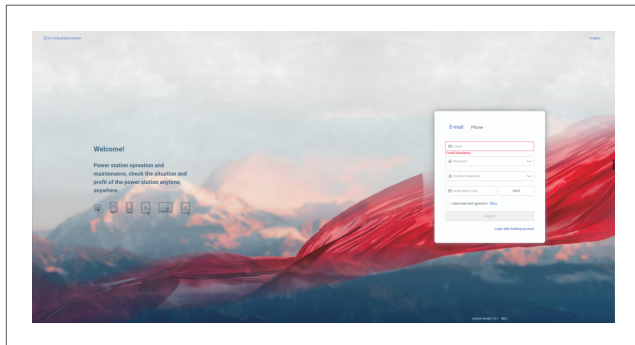

2.2.2 Password Modification

Go to 「Me」 - 「Settings」 - 「Modify password」 to change your password.

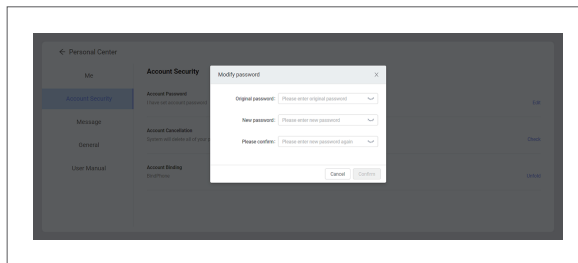
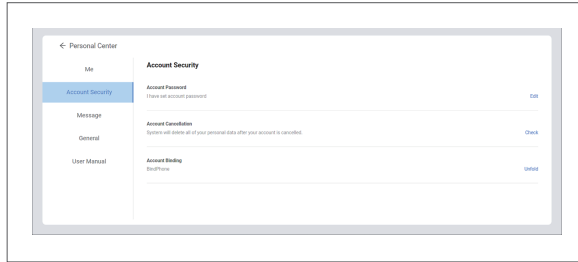

2.3 Account Binding

Go to 「Me」 - 「Settings」 - 「Account Binding」 to bind your account with your main contact way.

- You can log in via your main contact way after the binding is done.
- Some functions (e.g. send alerts to E-mail) are available for you after the binding is done.

Binding Methods:

- 1.1. Phone Number (China, America, Brazil and Netherlands);
2. E-mail;
3. Username;
4. WeChat;
5. QQ.

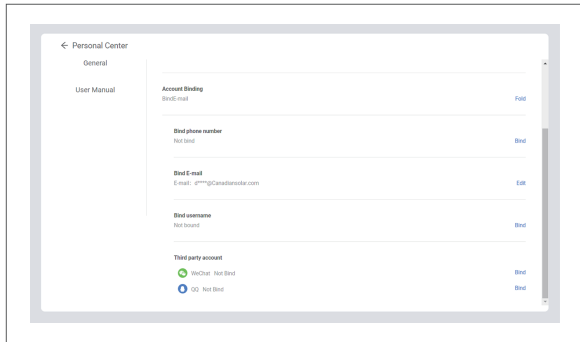

2.4 Account Cancellation

Step 1 Go to 「Account Cancellation」 Page

「Me」 - 「Account Security」 - 「Account Cancellation」

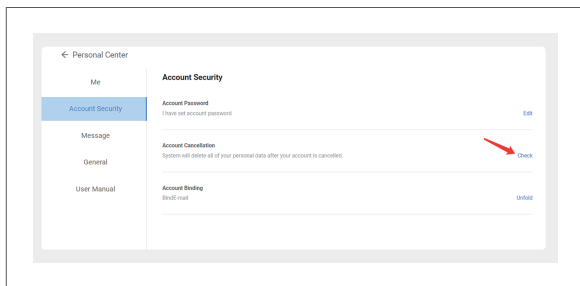

Step 2 Read Cancellation Notice

Please read the following instructions carefully before you apply for cancellation of your account.

- 1.1. Please back up your data (e.g. Production Data, Grid-tied Data, SN and etc.) in advance to avoid unnecessary losses.
2. Your plant data (e.g. Production Data, Grid-tied Data, SN and etc.) will be erased permanently after your account is cancelled, which is unable to recover.
3. Your personal data will be erased permanently after your account is cancelled, which is unable to recover.

The connections between the account and business units will be erased

4. permanently after your account is cancelled, which is unable to recover. And the business unit will not be able to use this software.

5. All data will be erased permanently after your account is cancelled, which is unable to recover.

6. You can create a new account after this account is cancelled.

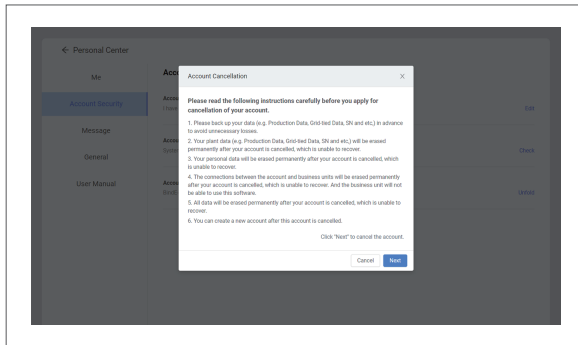

Click "Next" to continue.

Step 3 Select Reason of Cancellation

Please select your reason of cancellation according to your own situation. Or you can select "Others" and enter your reason manually.

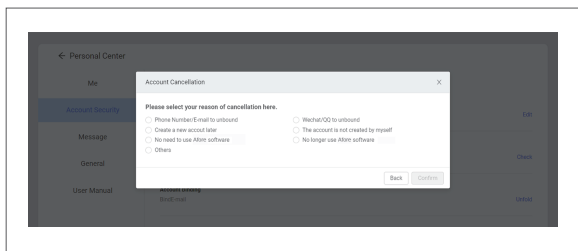

Click "Next" to continue.



Note:

AAccount that has data on Afore Business can't be cancelled from Afore Smart HOME.

Step 4 Phone Number/E-mail Verification

If your account has bound to phone number or E-mail, phone number/E-mail verification will be required.

You can select either method for verification.

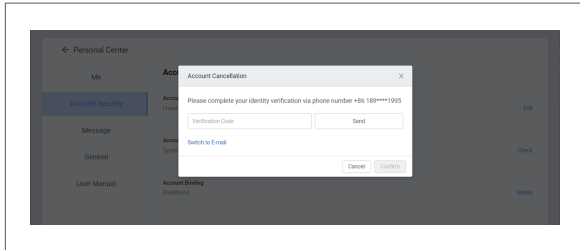

After entering the verification code, click "Confirm".



Note:

If your account has not bound to phone number or E-mail, please skip this step.

Step 5 Final Confirmation

Please read the content in popup carefully and make your final confirmation here.

Application review period is 7 days. You can cancel the application within 7 days freely. Otherwise, system will delete your account after 7 days and all data will be erased together.

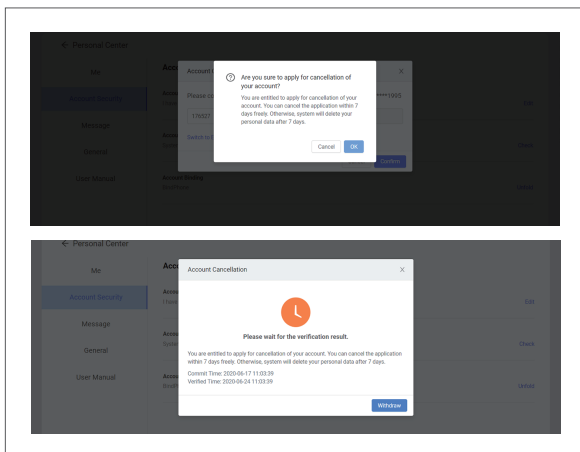

3.Plant

3.1 Create a plant

You can create your own plant at Afore Smart HOME to run a real-time monitoring. System will collect and calculate data from associated devices, which enables a full understanding of PV plant running status.

Step 1 Create a Plant

Click "Create" to create your plant on Afore Smart HOME.



Note:

If you have already created a plant, you will not see the following page. And if you wish to create another plant, please go to homepage and click "Create".

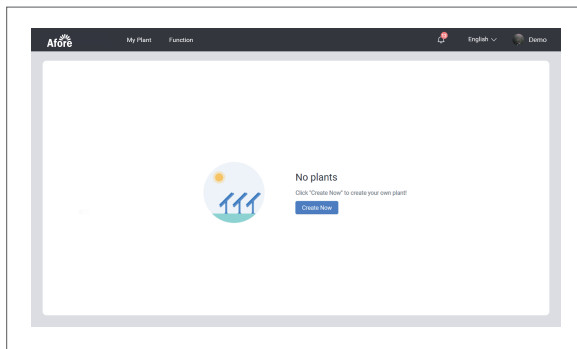

Step 2 Enter Plant Details

Please enter detailed plant information according to your actual situation. System will create an unique plant for you. In order to calculate plant data precisely, please enter.

- (1) Plant Name,
- (2) Plant Type,
- (3) Grid Type,
- (4) Plant Location,
- (5) Installed Capacity,
- (6) Time Zone,
- (7) Other information.

The screenshot shows a 'Create' form with three main sections: Basic info, System info, and Yield info. The Basic info section includes a 'Plant Name' field, a 'Plant Location' map, and fields for 'Coordinates', 'Administrative Area' (City, Province, and District), 'Address', and 'Time Zone'. The System info section includes 'Plant Type' and 'System Type' dropdowns, 'Installed Capacity (Unit: kWp)', and 'Operating Date'. The Yield info section includes 'Currency', 'Unit Price (Unit: CNY/kWh)', 'Total Cost (Unit: CNY)', and 'Total Construction Cost'. A 'Finish' button is located at the bottom of the form.

Click “Finish” to complete the creation.

If there is no data in your plant, which means you have not added a device in your plant.

3.2 Add a Logger

After the plant is created, you can add a logger. Logger can collect running data from PV devices and upload to server, which enables a full understanding of PV plant running status and revenue information. Furthermore, Afore Smart HOME will determine whether the plant is running normally, which avoid property losses caused by device failure and other reasons.

Step 1 Select a Plant

In case you have various power plants, which might cause data corruption, it is recommended to select a plant first before adding a logger.

Please follow "Red Outline" below. Select a plant first, then click "Add a Logger".

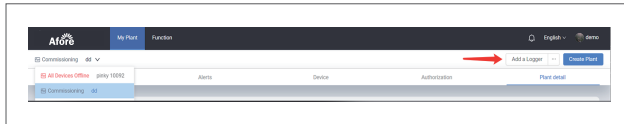

Step 2 Enter Logger SN

SN can be found on the product box. If the product box has been lost, you can find SN on product body.

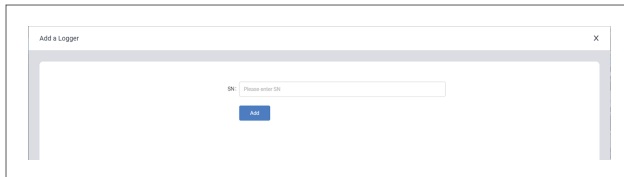

Step 3 Select Authorization Mode

When you add a logger, it is required to select authorization mode. System will add a device to your plant according to your authorization mode.

- (1) Select authorized device automatically

Default authorization mode: Select authorized device automatically. If you select this mode, devices connected to logger will be added to the plant automatically.

- (2) Select authorized device manually

If you select authorized device manually, it is required to select the device connected to logger first, then add the target devices to the plant. If the logger does not have normal networking or devices have no connection with the logger at this period, you can go to 「Device Details」 and add device manually when it runs normally.



Note:
Once the device has been added to the plant, authorization mode cannot be changed. (Default authorization mode: Select authorized device automatically.)

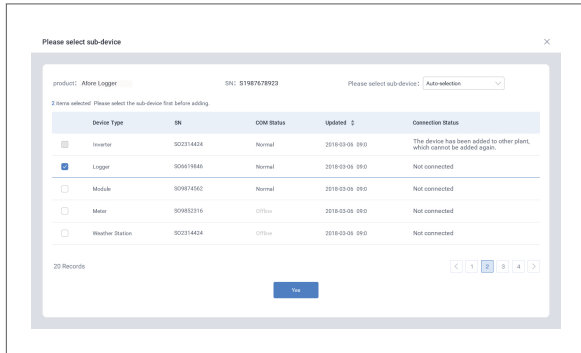

Step 4 Finish

After finish adding, you can check gateway/logger data on "Device Details" page.

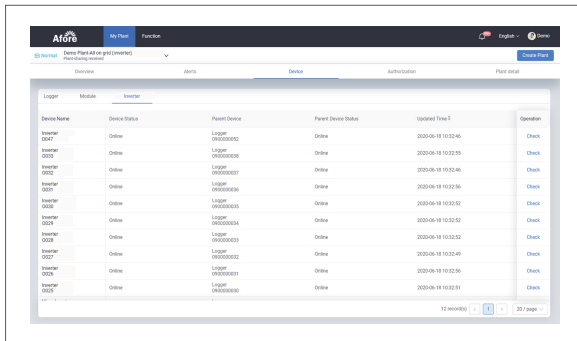

If the logger is equipped with a WiFi module, please know the following information:

- (1) Wi-Fi module/gateway is not capable of communication, which cannot transmit data directly.
- (2) If you wish your logger is capable of communication, it is required to operate networking configuration first. Please download Afore Smart HOME App to

configure. Afore Smart HOME Web is not supported.



(3) After networking configuration is done, it means the logger is capable of communication, which can transmit data to server. Then you can check plant data on Afore Smart HOME Web.

(4) Due to network and server connection reasons, please wait about 5-10 mins to check the data after the configuration is done.

3.3 Data View

After the plant and device setup is done, you can check plant data and operate now.

Go to "Red Outline" below to switch plant.

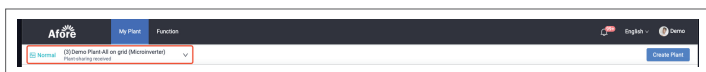

Our recommendations:

- If your device (e.g. inverter) only acquires production data and transmits data to grid, it is recommended that you choose "All on Grid" as your plant system type;
- If your device (e.g. inverter) acquires production data and consumption data at the same time, it is recommended that you choose "Self-consumption" as your plant system type;
- If your device (e.g. inverter) acquires production data, consumption data, battery data and grid data at the same time, it is recommended that you choose "Storage System" as your plant system type.

3.3.1 Plant Data

Click "Plant Data" to check various data on this page. E.g. Total Production, Total Grid Feed-in, Total Anticipated Revenue, Self-used Rate, Total CO2 Emission Reduction, Running Days, 24H Curve, Local Weather, Historical Data and etc..

Definition:

Total Production: Total production generated from devices under the current plant.

Total Grid Feed-in: Total capacity fed into the grid.

Total Anticipated Revenue: Comprehensive calculation of feed-in tariff according to current production and grid feed-in.

Self-used Rate: Proportion of production applied to household consumption.

Running Days: Total serving days.

Total CO2 Emission Reduction: Reduced CO2 emission since current plant went into service.



3.3.2 Plant Alert

Click "Plant Alert" on this page. Alert will be distinguished from alert grade and alert influence, which enables you to understand the importance of alerts. Through these alert message, users can learn the fault status of your plant, which avoids property losses.

Alert Name	Device	Importance	Range of Influence	Last Alert Time	Operate
Grid Over Current	Breaker AV48T023PV124	Prompt	Influence Production	2020-06-17 17:40:04	Check
Off-line	Logger DMS00000173	Warning	No influence	2020-06-17 09:12:50	Check
Off-line	Logger DMS00000171	Warning	No influence	2020-06-16 16:13:13	Check
Off-line	Logger DMS00000172	Warning	No influence	2020-06-16 16:13:13	Check
Off-line	Logger DMS00000173	Warning	No influence	2020-06-30 02:04:45	Check
Off-line	Logger DMS00000171	Warning	No influence	2020-05-29 16:13:15	Check
Off-line	Logger DMS00000172	Warning	No influence	2020-05-29 16:13:15	Check
Grid Over Current	Breaker AV48T023PV124	Prompt	Influence Production	2020-05-29 17:34:26	Check

Alert Overview

Plant Name: 12520000 Plant Industrial Device Name: Breaker SN: AV48T023PV124
 Range of Influence: Influence Production Importance: Prompt Last Alert Time: 2020-06-17 17:40:04

Problem Description

-

Reason/Solutions

Reason:
 Solution:
 1. Verify that the grid is properly connected. 2. Check if the connected power grid is normal. 3. If the main connection is normal, you need to contact our maintenance staff member.

Time Distribution

Grid Over Current

Time axis: 09:00, 12:00, 15:00, 18:00, 21:00

Bar chart showing a red bar between approximately 12:00 and 15:00.

3.3.3 Device Info

Click "Device Info" on this page, including real-time parameters and statistical charts. From these data, you can check if the device is running normally. Moreover, users can operate meter configuration, selection and unbounding of associated devices.

Device Name	Device Status	Parent Device	Parent Device Status	Production Power	Production Today (kWh)	Updated Time 2	Operation
Inverter #20 INV01TEGSPV046	Online	Logger 990000072	Online	20W	411.6088	2020-06-17 17:55:52	Check
Inverter #21 INV01TEGSPV038	Online	Logger 990000072	Online	20W	411.6088	2020-06-17 17:55:51	Check
Inverter #22 INV01TEGSPV039	Online	Logger 990000072	Online	20W	411.6088	2020-06-17 17:55:51	Check
Inverter #23 INV01TEGSPV033	Online	Logger 990000072	Online	20W	411.6088	2020-06-17 17:55:50	Check
Inverter #24 INV01TEGSPV034	Online	Logger 990000072	Online	20W	411.6088	2020-06-17 17:55:50	Check
Inverter #25 INV01TEGSPV035	Online	Logger 990000072	Online	20W	411.6088	2020-06-17 17:55:49	Check
Inverter #26 INV01TEGSPV036	Online	Logger 990000072	Online	20W	411.6088	2020-06-17 17:55:49	Check
Inverter #27 INV01TEGSPV037	Online	Logger 990000072	Online	20W	411.6088	2020-06-17 17:55:48	Check
Inverter #28 INV01TEGSPV032	Online	Logger 990000072	Online	20W	411.6088	2020-06-17 17:55:48	Check
Inverter #29 INV01TEGSPV031	Online	Logger 990000072	Online	20W	411.6088	2020-06-17 17:55:48	Check

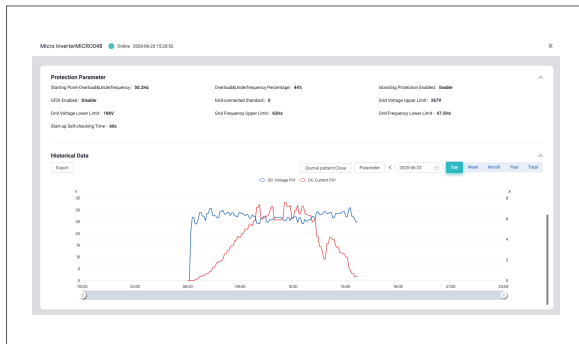

3.3.4 Plant Details

Click "Plant Details" to check plant detailed information. Click "Edit" to modify or perfect information here.

Basic Info

- Plant Name: W01 Device Plant
- Invoice Code: 0020-04-08
- Invoice Code: 零壹陆
- Time Code: 017148-003 Beijing-Chengde-Hong Kong (China)
- Plant Location: ChengdeMaotaiWuJiaTian's Intelligent Park A2 Industrial Buid.

System Info

- Plant Type: Residential Rooftop
- System Type: All in Grid
- Operating Date: 2020-04-08
- Address: --
- Inverter Capacity: 30kW
- Angle of tilt: --

Yield Info

- Company: CNV
- User Pkce: --
- Total Cost: --

3.4 Plant Authorization

Click "Authorization Info" to check plant authorization information. According to plant property, there are two types of plant. One is created by myself. Another is authorized by others.

(1) Plant created by myself

Please refer to authorization steps. Users can authorize the plant to your service provider. After that, the authorized service provider can check your plant data and operate your device. The authorization scope is determined by the role you set for the service provider.

- If the server provider is "Ordinary Member", then it can check all plant data.
- If the server provider is "Admin", then it can check all plant data and operate the plant/device.

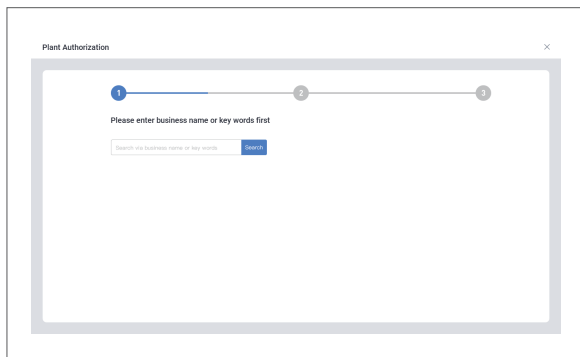
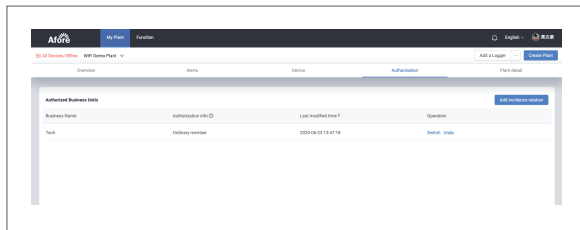

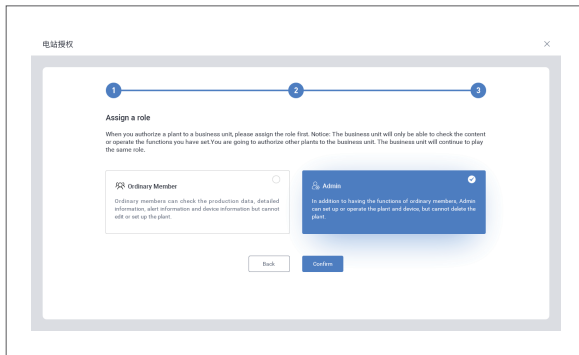
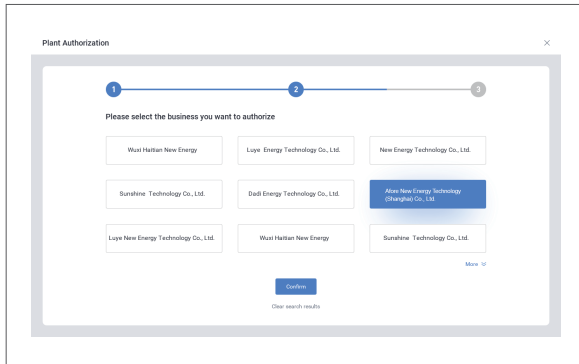

(2) Plant authorized by others

Currently, the service provider can authorize the plant to users. Users can check data of authorized plants within the permissions.

Users cannot authorize such plants to others

If users do not wish to follow the plant, click "Delete Plant".

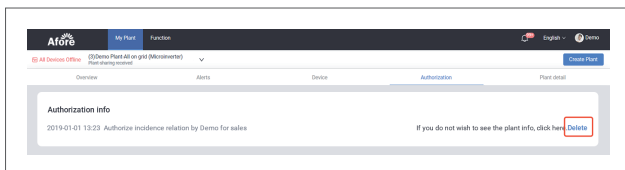

3.5 Plant Settings

Go to "Red Outline" below to set your plant.

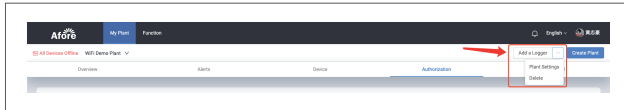

3.5.1 Delete Plant

If the plant is created via current account, users can delete the plant here.



Note:

All data will be erased permanently after the plant is deleted, which is unable to recover.

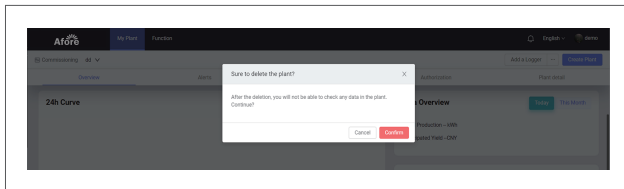

3.5.2 Plant Settings

1. Preconditions of Plant Settings (Meet arbitrary conditions below)

- (1) The plant is created via current login account.
- (2) The plant is authorized by service provider, which has permissions to set plant.

2. Supported Plant Settings :

(1) Calculation of Accumulated Production

Users can set rules of taking figures for production, consumption, grid feed-in, electricity purchasing, energy charged, energy discharged.

Default: via accumulated production uploaded by devices.

Users can select via daily production summation manually and system will no longer use device data as the benchmark, platform calculation instead.

Platform Calculation = Daily production summation within the selected time period E.g.:

Accumulated Production in 30 days= Production on 1st June + Production on 2nd June + + Production on 30th June

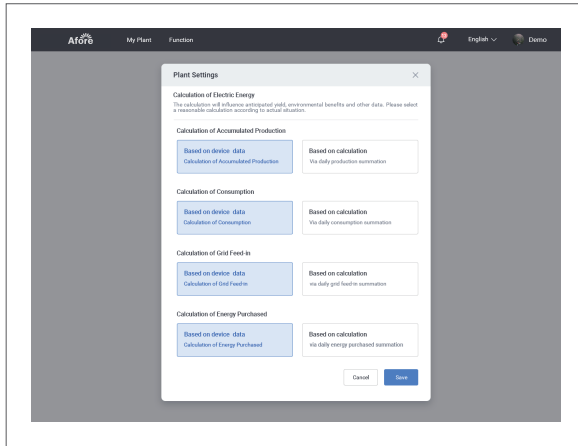

(2) Data Source

Users can set the data source for production, grid, consumption and battery to ensure data accuracy.

Default: Intelligent Selection. System will select data source based on plant actual situation. Or you can modify it manually.

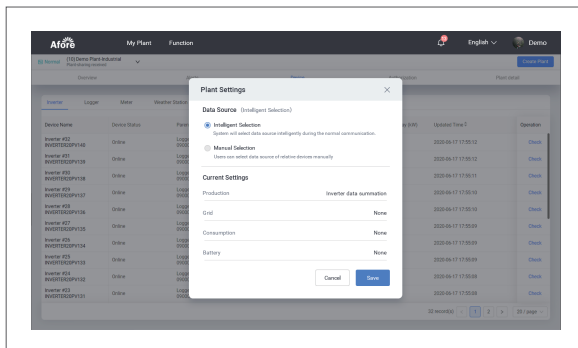

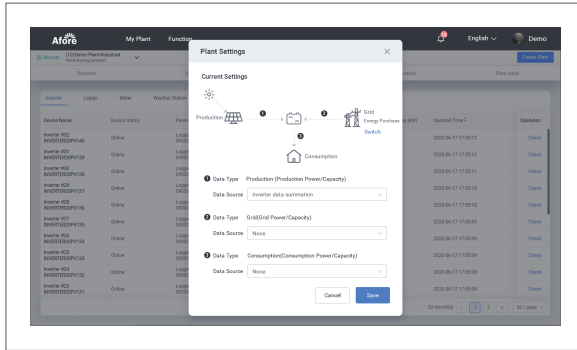

(3) Zero Setting for Production Power

Zero Setting for Production Power is applicable to the situation that the production power is zero when no power is generated at night. System will automatically zero up the production power in this period after applying this setting. (This setting is generally used for self-consumption system.)

Meet all three preconditions of zero setting below

- 1.Current time is within Effective Time.
- 2.Inverters or other generating devices do not upload production data.
- 3.Data source on Generation-side is not "None".

Due to local sunrise and sunset time change seasonally, the period of no power generated at night changes synchronously. It is recommended that set Effective Time as From Sunset to Sunrise, which means system will set effective time according to actual sunset and sunrise time.

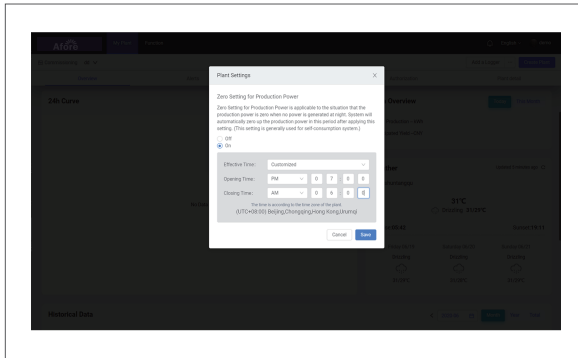
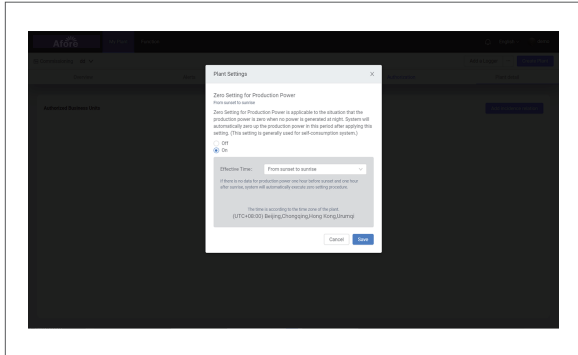

4.Message

4.1 Messaging

Go to "Messaging" in the upper-right corner. System will list plant message, alert message and notification here.



Note:

Currently, you can only receive plant alert message here.

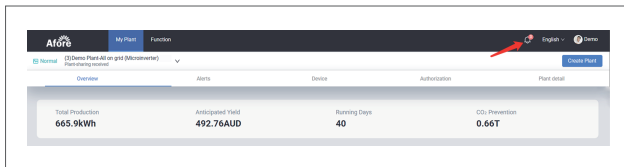

Click "Messaging" to check more details.

- (1) Icon 1: Mark all message as read.
- (2) Icon 2: Go to 「Block List」, users can restore block settings here.
- (3) Icon 3: Block current alert or restore current alert. After the blocking, such alerts will no longer be pushed.
- (4) Icon 4: Go to 「Alert Details」.

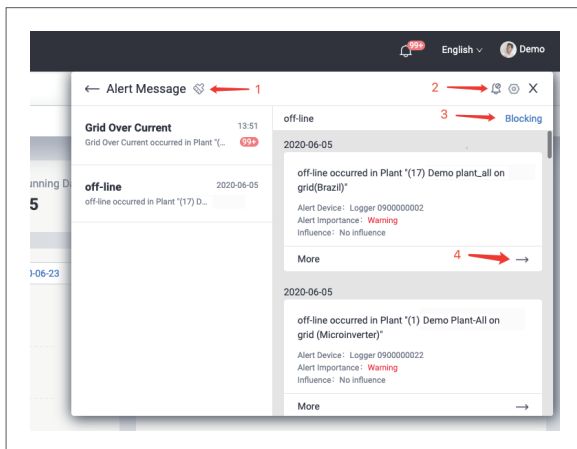

4.2 Message Settings

Go to 「Me」 - 「Message Settings」, users can set alert message here.

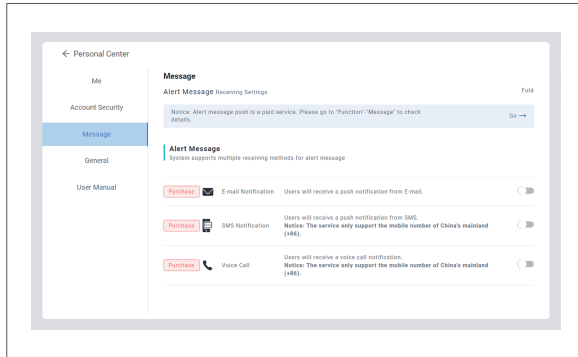

4.2.1 Receive Alert Message

Afore Smart HOME Web pushes all alert message for free. System also supports three other receiving methods, which is a paid service.

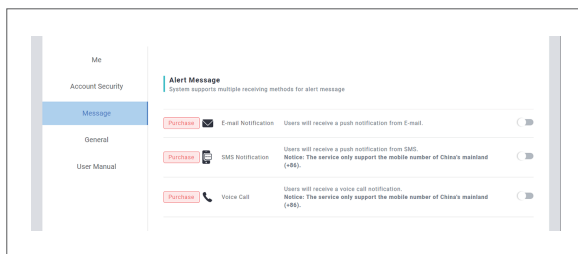

1. E-mail Notification | Paid Service

Users will receive a push notification from E-mail, which is convenient to receive through smart terminals such as PC / tablet / mobile phone. Currently, "service plan" is in trial operation period, each account can enjoy 500 E-mail notifications for free.

2. SMS Notification | Paid Service

Users will receive a push notification from SMS, which is convenient to receive through smart terminals such as tablet / mobile phone. Currently, "service plan" is in trial operation period, each account can enjoy 250 SMS notifications for free.



Note:
This service only support the mobile number of China's mainland (+86).

3. Voice Call Notification | Paid Service

Users will receive a push notification from voice call, which is convenient to receive through smart terminals such as PC / tablet / mobile phone. Currently, "service plan" is in trial operation period, each account can enjoy 50 voice call notifications for free.



Note:
This service only support the mobile number of China's mainland (+86).

4.2.2 Alert Range Settings

Afore Smart HOME will classify all alert importance. Users can set alert range reasonably, which can reduce the disturbance caused by unimportant alert.

- Prompt Message: This kind alert occurs frequently, but it will not affect the normal operation of power plant.
- Warning Message: This kind alert will happen, which is generally manifested as abnormal data in a short period.
- Failure Message: The frequency of this kind alert is low, which needs to be paid special attention to.

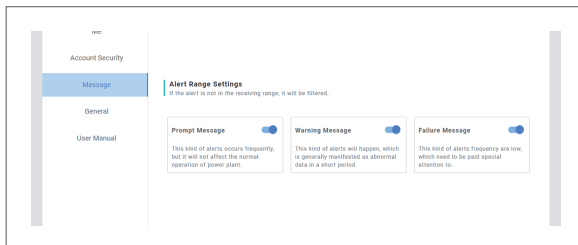

4.2.3 Alert Frequency Settings

Currently, device data will be sent to Afore platform periodically following a certain frequency. Users can set alert frequency reasonably, which can reduce the disturbance caused by unimportant alert or false alert.

For example:

- (1) If you set Trigger Times: 1, Afore platform will notify you immediately when the alert data has been uploaded. One alert data means one alert notification.
- (2) If you set Trigger Times: 3, Afore platform will notify you when it has received three same alert data. Three same alert data means one alert notification.

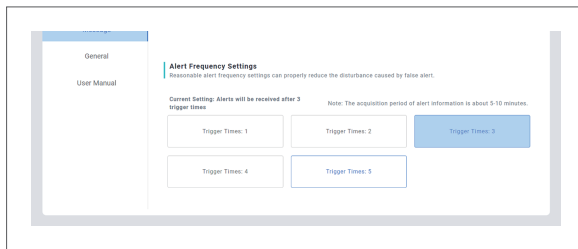

4.3 Service Plan

Afore Smart HOME supports multiple receiving methods for alert message. Users can receive message via SMS, Voice Call and E-mail, which avoid property losses caused by device failure and other reasons.

Instructions:

- (1) Receiving alert message from SMS/Voice Call/E-mail is a paid service.
- (2) Service Plan is in trial operation period, each account can enjoy 500 E-mail notifications/250 SMS notifications/50 voice call notifications for free. [Only support mobile number of China's mainland (+86)].
- (3) Message package purchases will be open soon, which will support global mobile number.

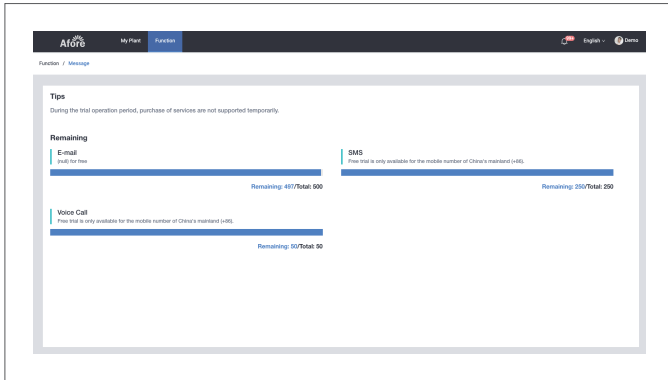
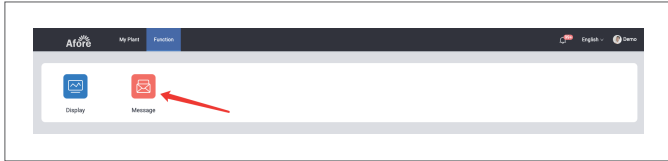

5.Applications

5.1 Full Screen Display

Currently, full screen display is available for household owners.

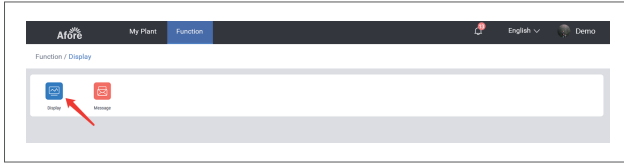

5.1.1 Steps

1. Click "Default Display" button.

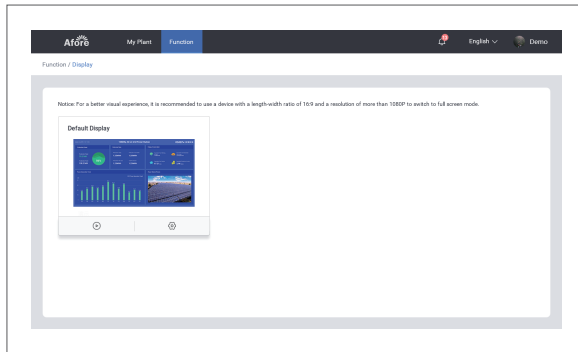

2. Select the target plant in the pop-up window.

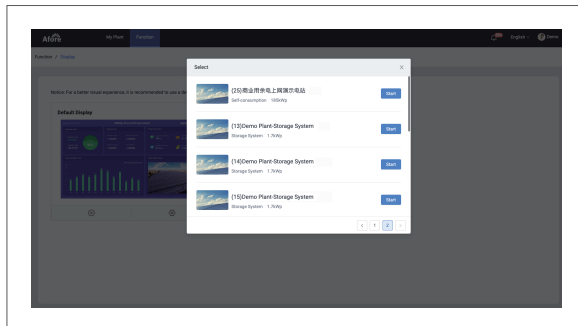

3. Click "Start" to go to full screen display. Plant data can be displayed on computer screen, LED screen or other intelligent terminals in full screen mode.

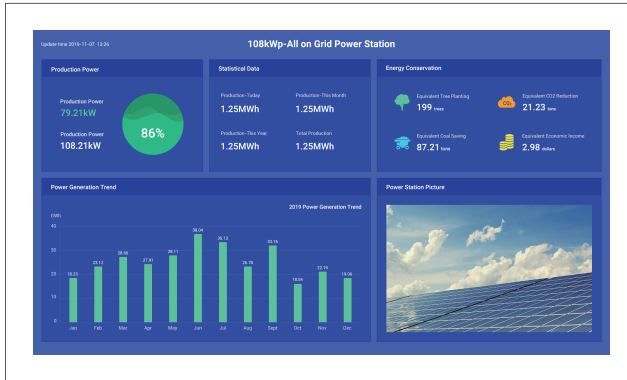

5.1.2 Settings

1. Click "Settings" button.

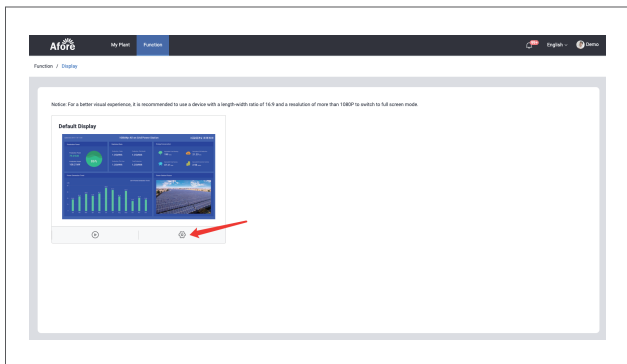

2. Customized Settings

-Skin: “Tech Blue”, “Cool Black”, “Classic White”.

-Logo: Support customized logo.

-Statistical Data: Select the display fields according to your own situation.

-Environmental Benefits: Select the display fields according to your own situation.

-Trend: Select the display fields according to your own situation.

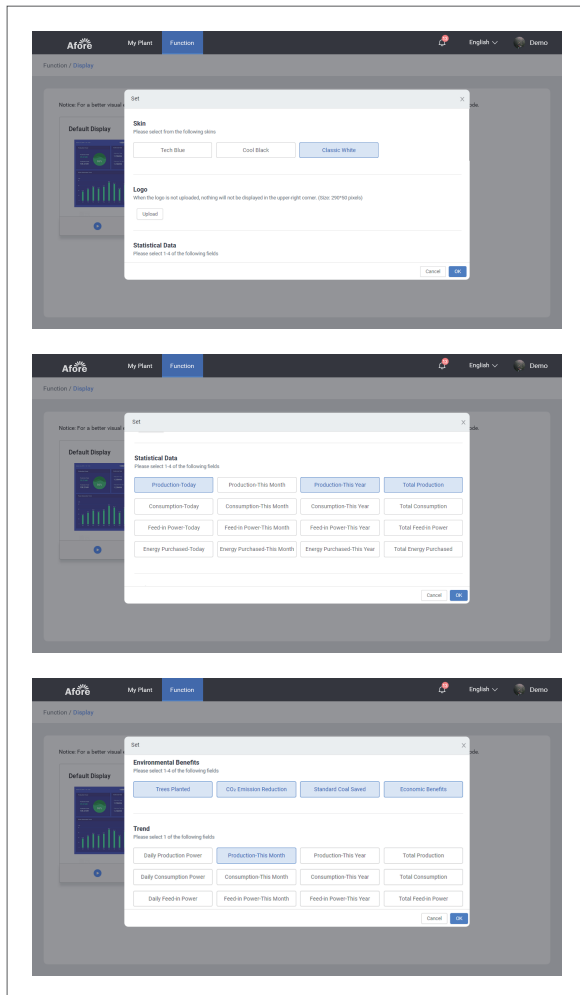

6.Others

6.1 Languages

Afore Smart HOME supports 5 languages for now, which are [简体中文](#), [English](#), [Español](#), [Português](#), [Polski](#).

Method 1:

Go to "Red Outline" below to switch language here.

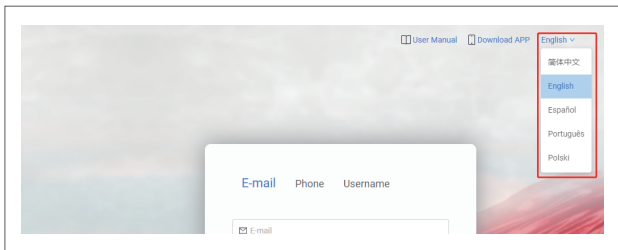

Method 2:

Go to "Red Outline" below. After you have logged in, you can select the suitable language in the drop-down menu.

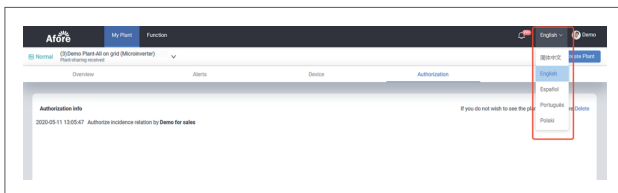

6.2 Common Operations

6.2.1 Log Out

Move the mouse pointer to account name in the upper-right corner and click "Log Out".

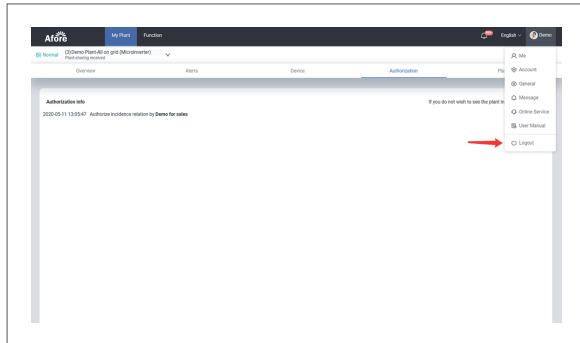

6.2.2 Personal Settings

Move the mouse pointer to account name in the upper-right corner and click "Personal Settings".

Click your avatar/nickname to modify your personal info.

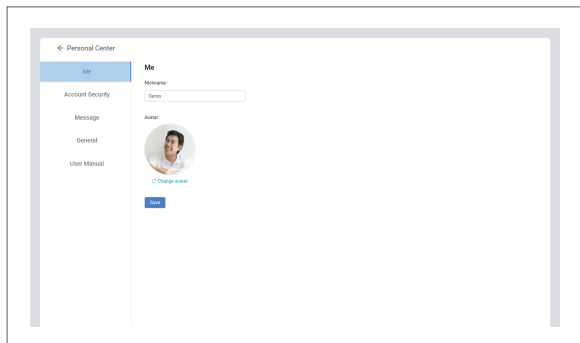

6.2.3 General

Move the mouse pointer to account name in the upper-right corner and click "General".

You can set temperature unit and language here.

