

Instructions of Networking Configuration for Data Logger (WiFi)

1. Open a wireless network.
2. Select logger network (network name: AP+SN) and connect. The password can be found on the logger label, which are the characters behind PWD.

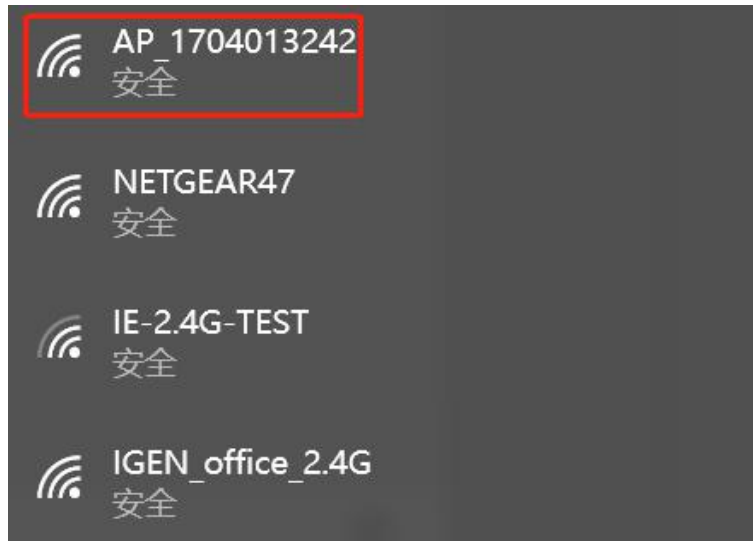

3. Open a browser and enter 10.10.100.254. Both username and password are admin. (Recommended browser: IE 8+, Chrome 15+, Firefox 10+.)

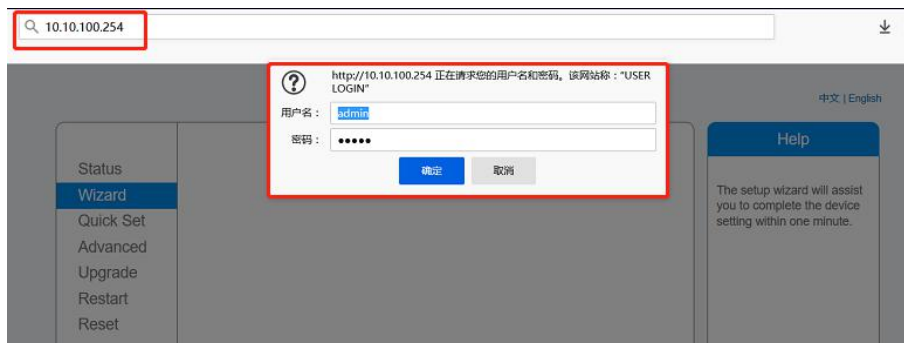

4. Go to logger setup page. The basic information are listed here.

中文 | English

Status

Wizard

Quick Set

Advanced

Upgrade

Restart

Reset

- Inverter information

Inverter serial number ---

Firmware version (main) ---

Firmware version (slave) ---

Inverter model ---

Rated power --- W

Current power --- W

Yield today --- kWh

Total yield --- kWh

Alerts ---

Last updated ---

- Device information

Device serial number 1704013242

Firmware version LSW3_14_FFFF_1.0.23

Wireless AP mode **Enable**

SSID AP_1704013242

IP address 10.10.100.254

MAC address 9C:D8:63:71:8D:B0

Wireless STA mode **Disable**

Router SSID

Signal Quality

IP address

MAC address

- Remote server information

Remote server A Not connected

Remote server B Not connected

Help

The device can be used as a wireless access point (AP mode) to facilitate users to configure the device, or it can also be used as a wireless information terminal (STA mode) to connect the remote server via wireless router.

Status of remote server

- Not connected: Connection to server failed last time. If under such status, please check the issues as follows: (1) check the device information to see whether IP address is obtained or not; (2) check if the router is connected to internet or not; (3) check if a firewall is set on the router or not;
- Connected: Connection to server successful last time;
- Unknown: No connection to server. Please check again in 5 minutes.

Web Ver:1.0.24

5. Go to setup guide, click Refresh to search the wireless network. Select the target network and connect.

Status

Wizard

Quick Set

Advanced

Upgrade

Restart

Reset

Please select your current wireless network:

<input checked="" type="radio"/> IE-2.4G-TEST	54:A7:3:70:99:13	82	1
<input type="radio"/> AP_1753738492	0:BE:D5:20:B8:2C	80	1
<input type="radio"/> IGEN_office_2.4G	30:EA:E7:36:B:36	78	2
<input type="radio"/> IGENTEST	0:BE:D5:20:B8:2A	76	1
<input type="radio"/>	E8:65:D4:F2:15:B8	74	6
<input type="radio"/>	90:5D:7C:97:95:29	74	1
<input type="radio"/> IGEN_office_2.4G	90:5D:7C:97:95:27	72	1
<input type="radio"/>	90:5D:7C:97:C9:E5	72	1
<input type="radio"/> AP_1719065936	30:EA:E7:36:CF:B2	70	1
<input type="radio"/> IGEN_office_2.4G	90:5D:7C:97:C9:E3	70	1
<input type="radio"/> TEST+™ ? = , ;	4A:E:EC:9E:C3:3E	70	11
<input type="radio"/> IGEN_office_2.4G	0:BE:D5:20:B7:EE	66	11
<input type="radio"/> AP_17075065	08:D8:83:76:BA:24	66	4

*Note: When RSSI of the selected WiFi network is lower than 15%, the connection may be unstable, please select other available network or shorten the distance between the device and router.

Refresh

Add wireless network manually:

Network name (SSID) (Note: case sensitive)

Encryption method

Encryption algorithm

Next

1 2 3 4

Help

The setup wizard will assist you to complete the device setting within one minute.

6. Enter the password and click Next.

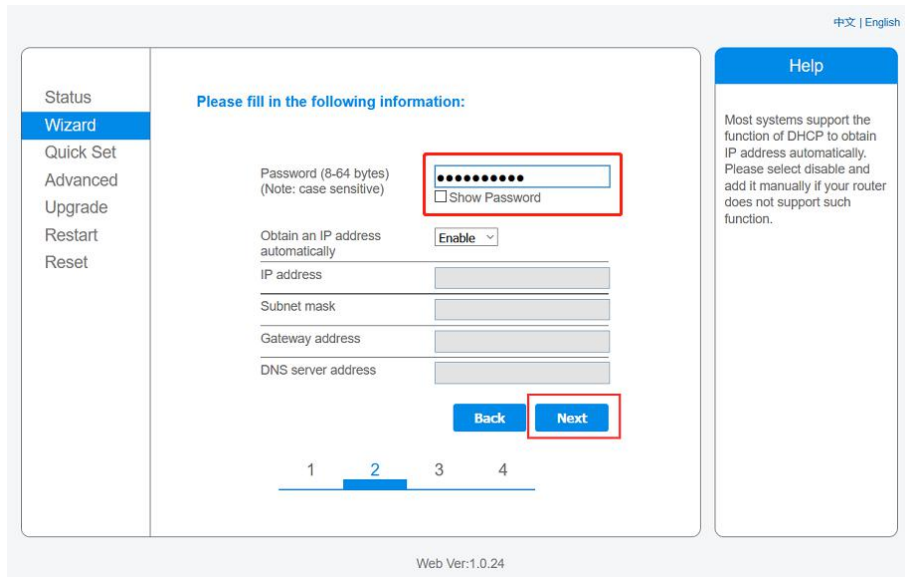

7. Users can select any options below to enhance the security and click Next.

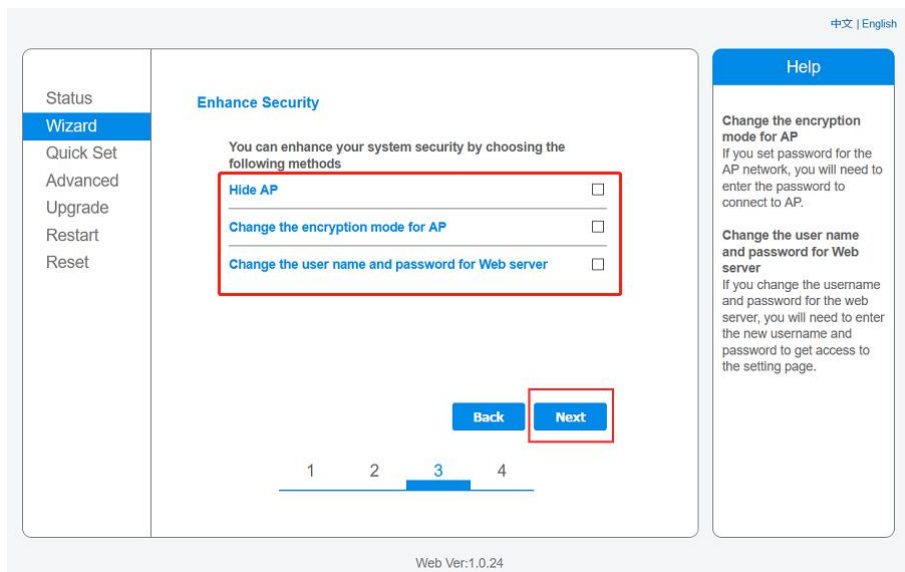

8. If the setup is successful, the following page will pop up and click OK to reboot the module.



9. Log in to 10.10.100.254 again and check system info here. After the network setting is done, wireless network STA mode is Enable. The info of router will be displayed on the page and the remote server A is connectable.

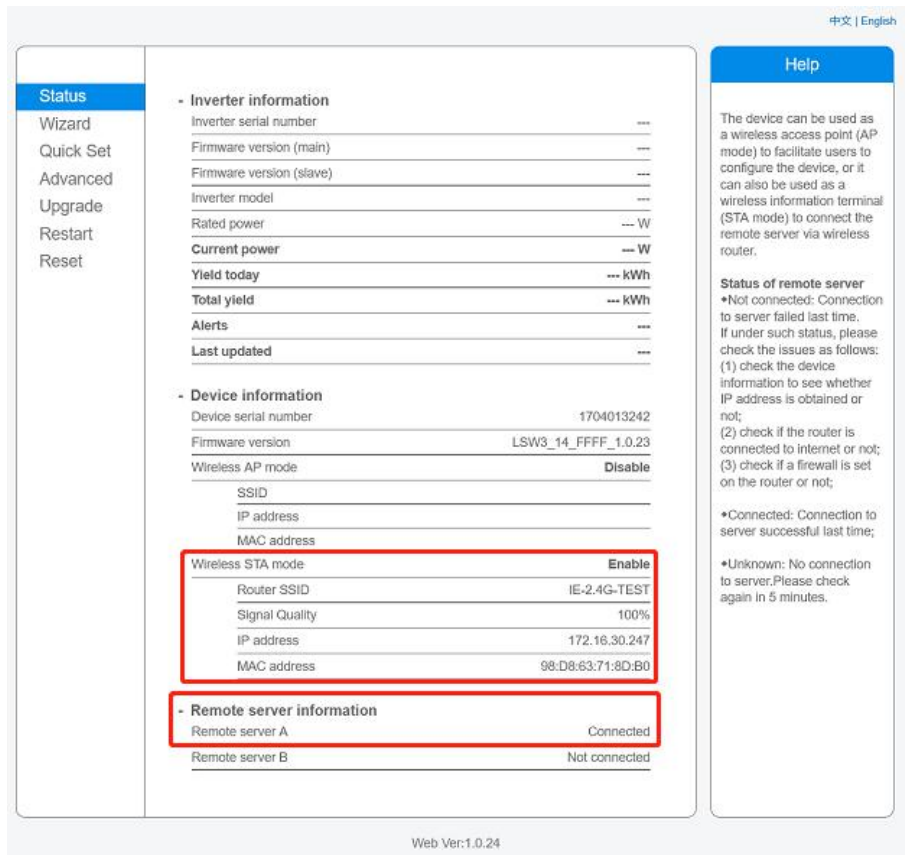

10. If the remote server is disconnectable, please refresh the page or try it again.